



iOS APP

version 4.0

1 - HOME SCREEN

Tap the menu icon to switch between different properties, access settings, and dark mode.

Customize the home screen with a photo and name of your home.

Be alerted to outstanding actions that require your immediate attention.

Quickly see and access devices that are on throughout the house.

Tap the microphone to give a voice command via the phone.

Navigate between your home screen, rooms, devices, and scenes.

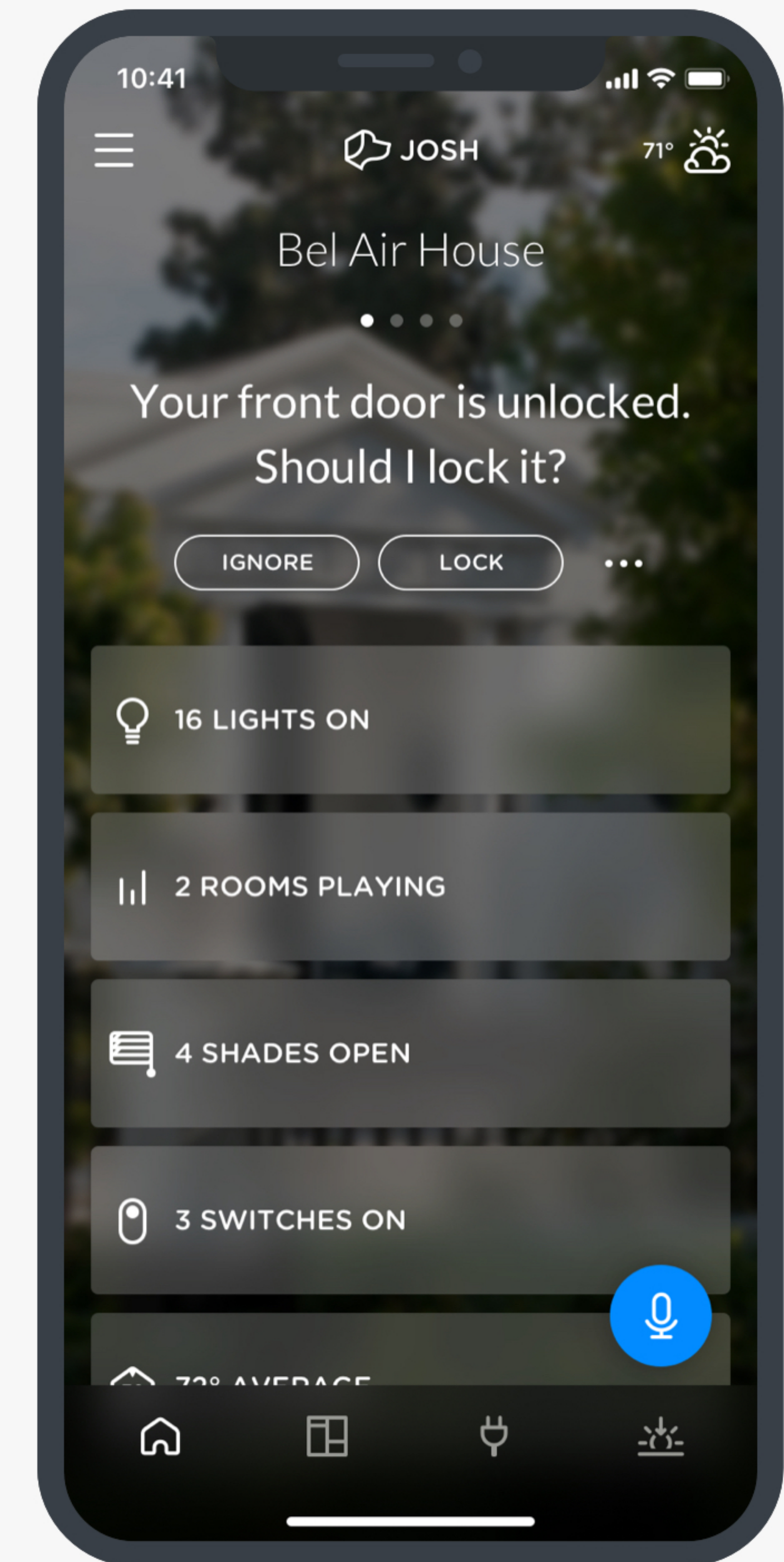
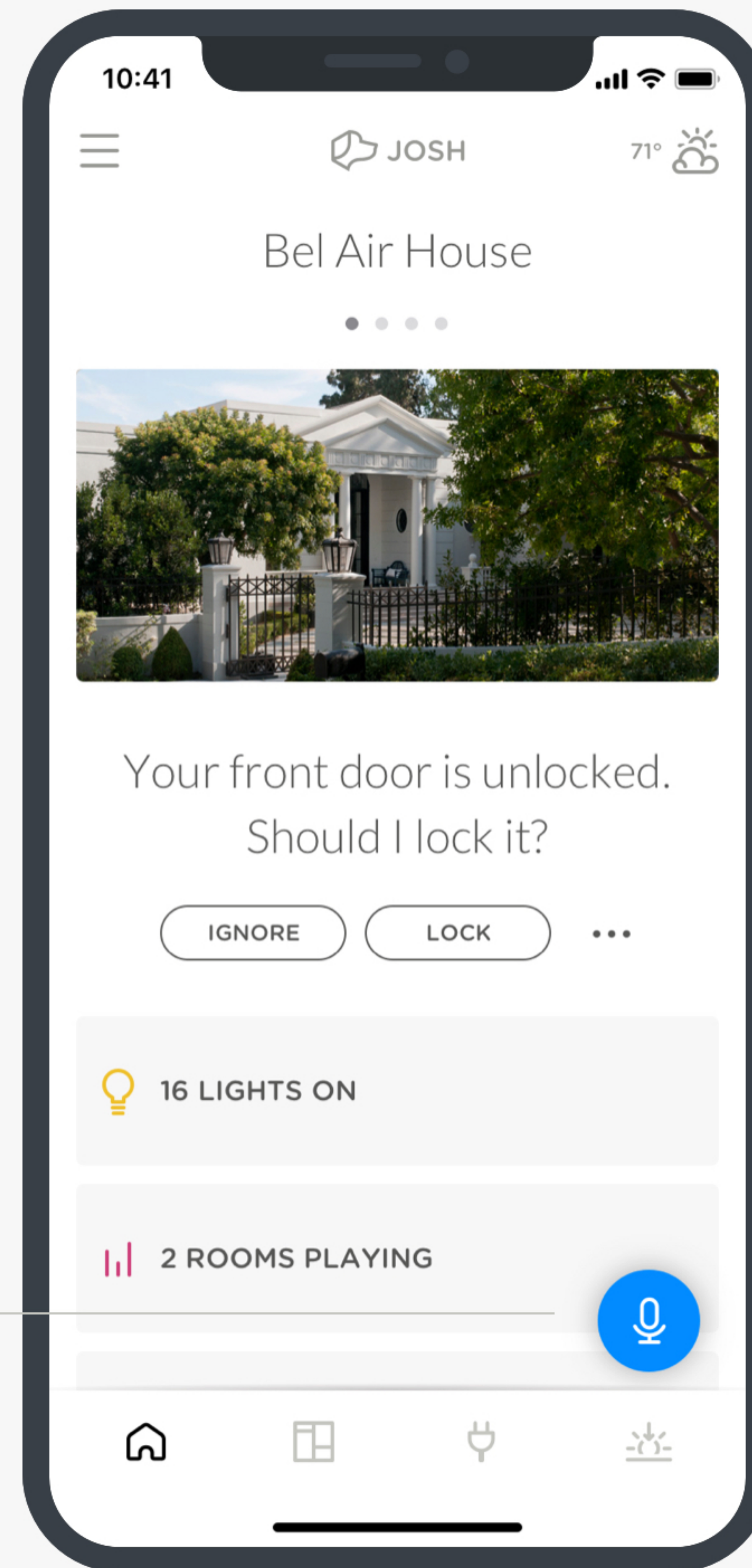

2 - VOICE CONTROL

Your command will show up as you speak so you can see what the system is hearing.

Tap “see devices” to adjust the devices affected by your command.

Tap the microphone button to issue another command, the keyboard to manually type a command, and the "x" to close the view.

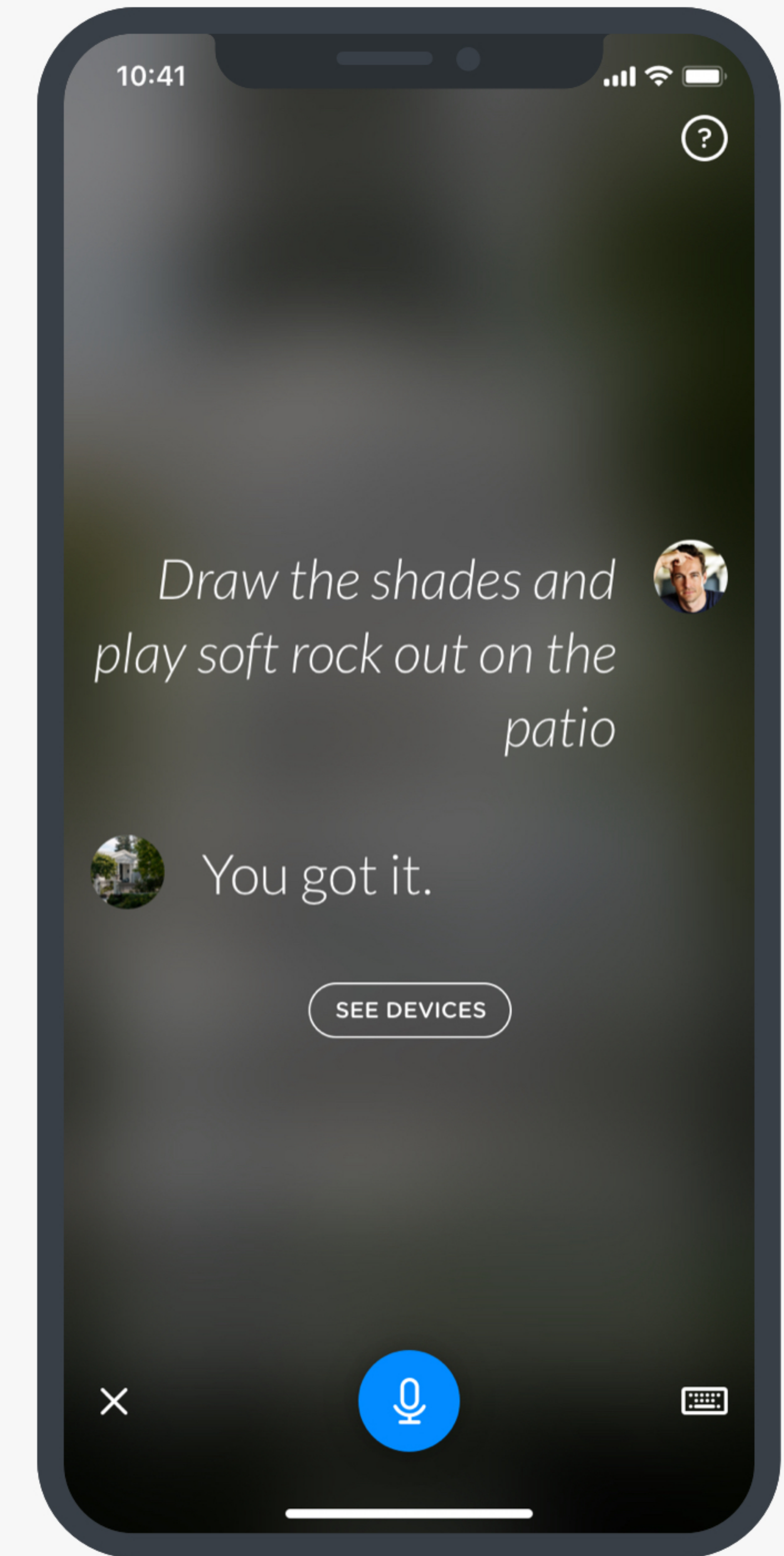

3 - DEVICES

Tap the "Devices" tab in the navigation bar to navigate directly to any device type.

Tap on any device category to control room by room, or tap the name of the room to view and control the individual devices as well.

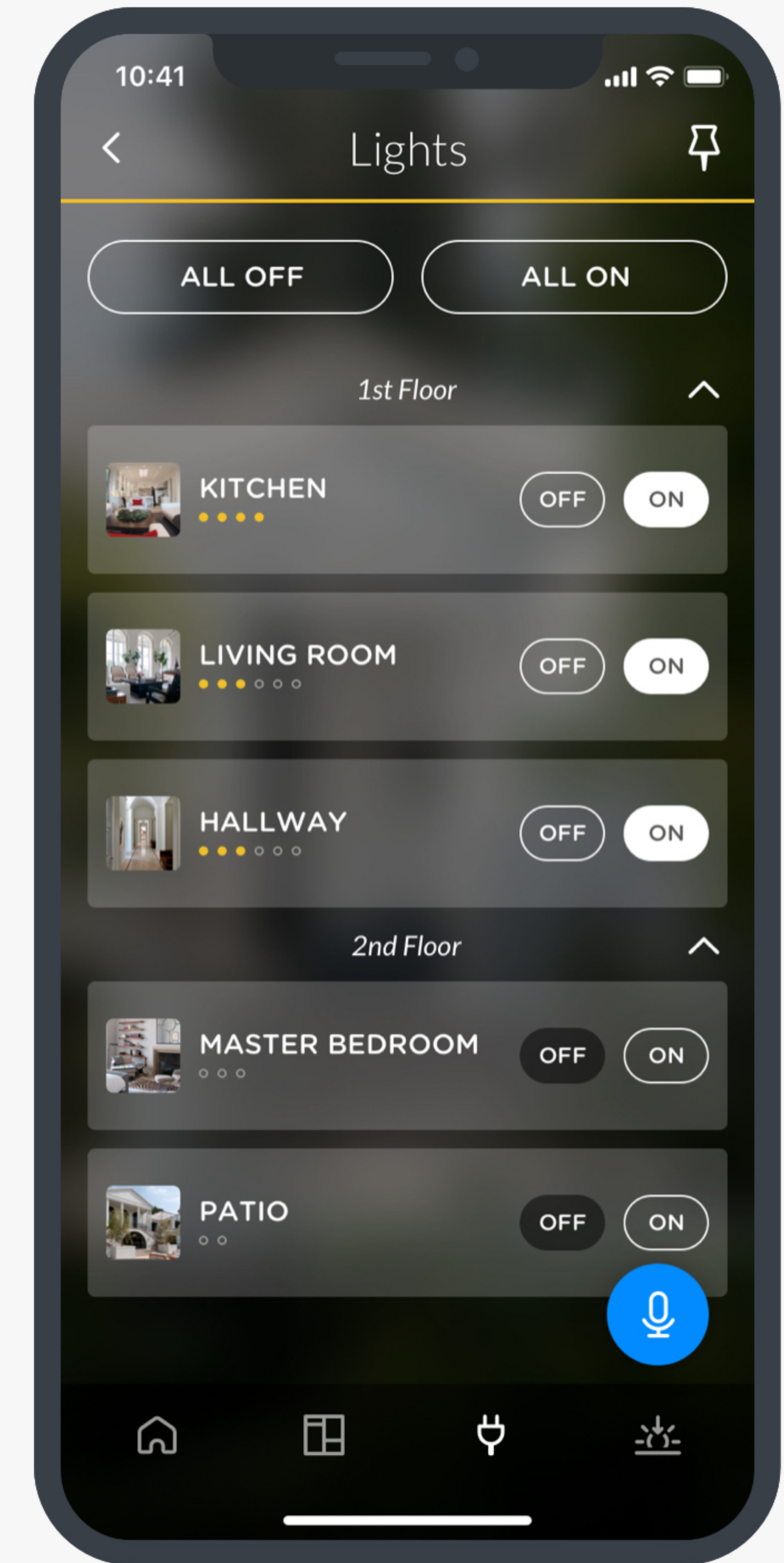
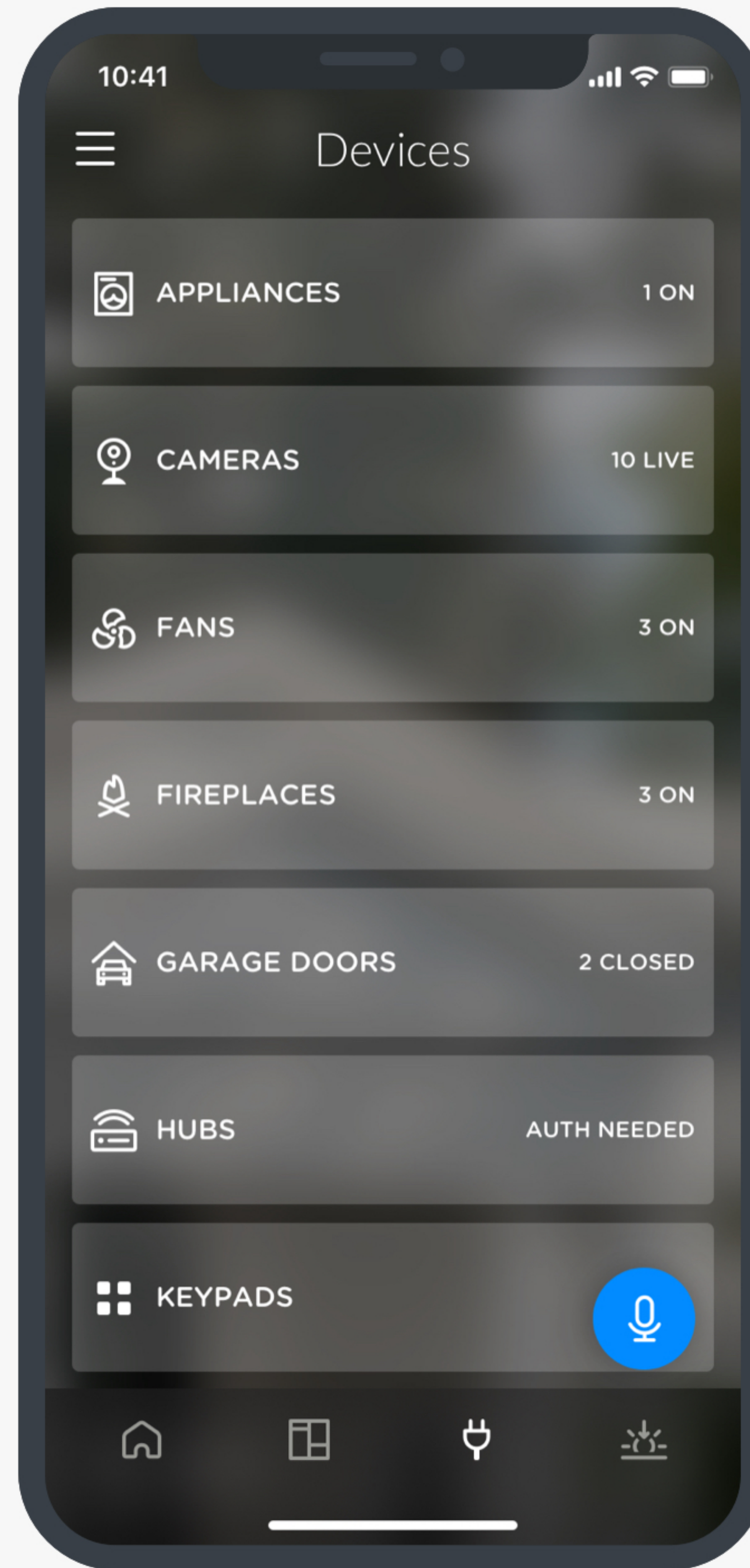

4 - ROOMS

Tap the "Rooms" tab in the navigation bar to navigate directly to any room.

Easily collapse and expand floors.



Control all the lights, music, or shades in a room with the room-level slider control at the top of the room view.

View and control any device in a room by tapping on a tile to open its controller.

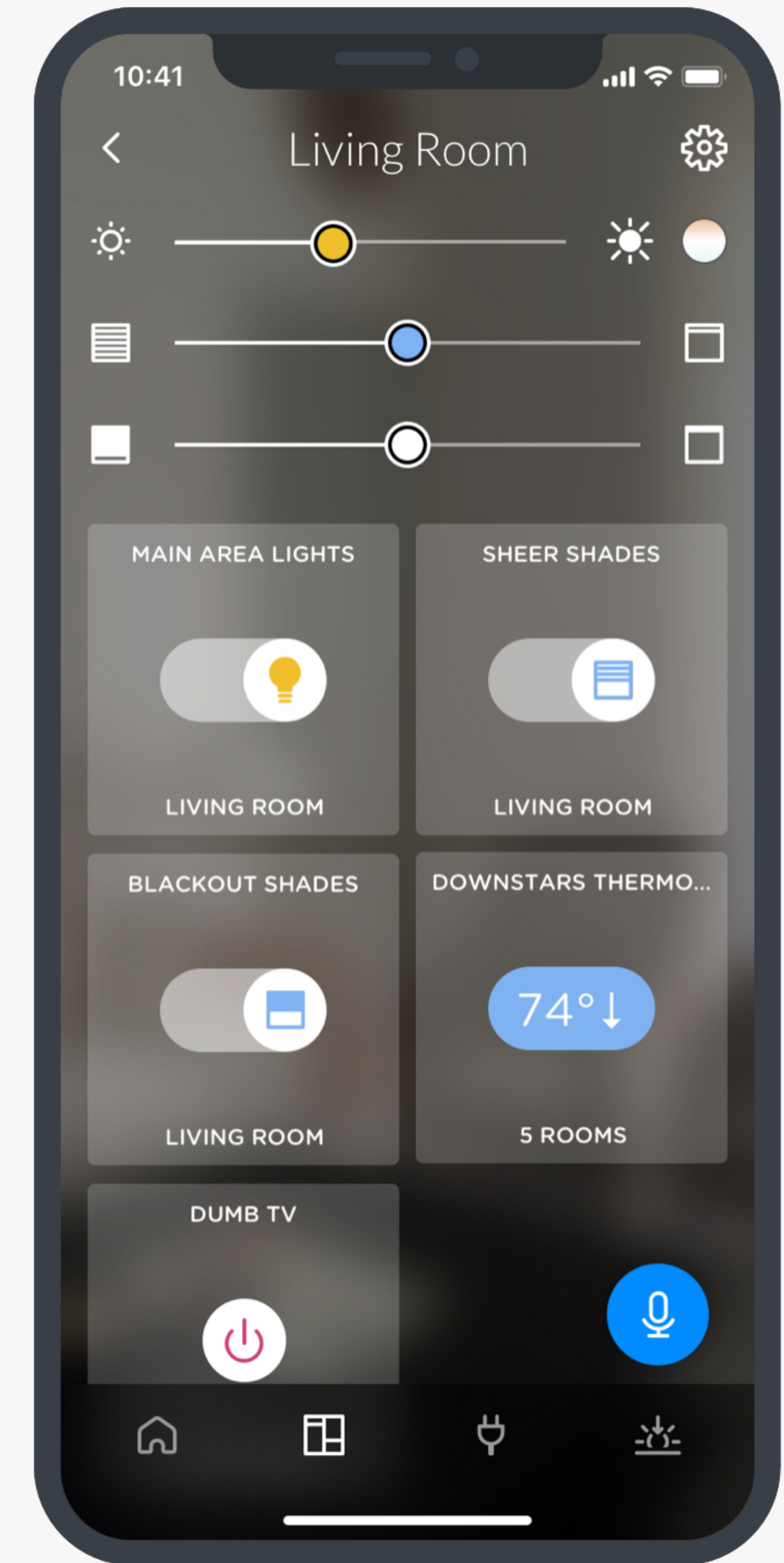
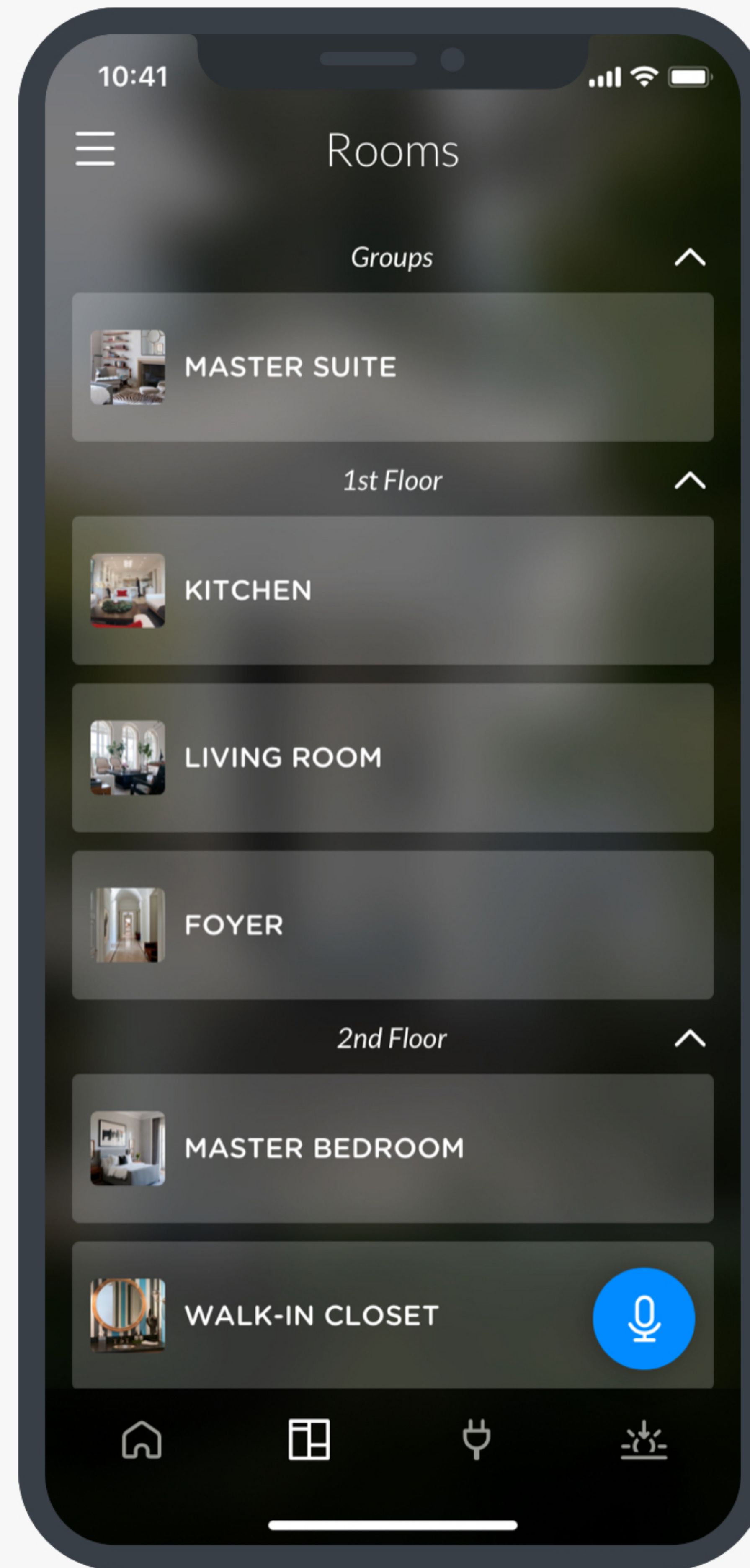

5 - SCENES

Scenes allow you to easily control a collection of devices with one simple button press or voice command.

Tap the "Scenes" tab in the navigation bar to navigate directly to any scene.

Tap the "run scene" icon on the right to run a scene. Tap the name on the left to view and edit the scene.



View/edit scene

Run scene

